



Installation manual  
Memjet Evo power module



**SHIVER**



## ECU installation diagram



## Detail of picture A

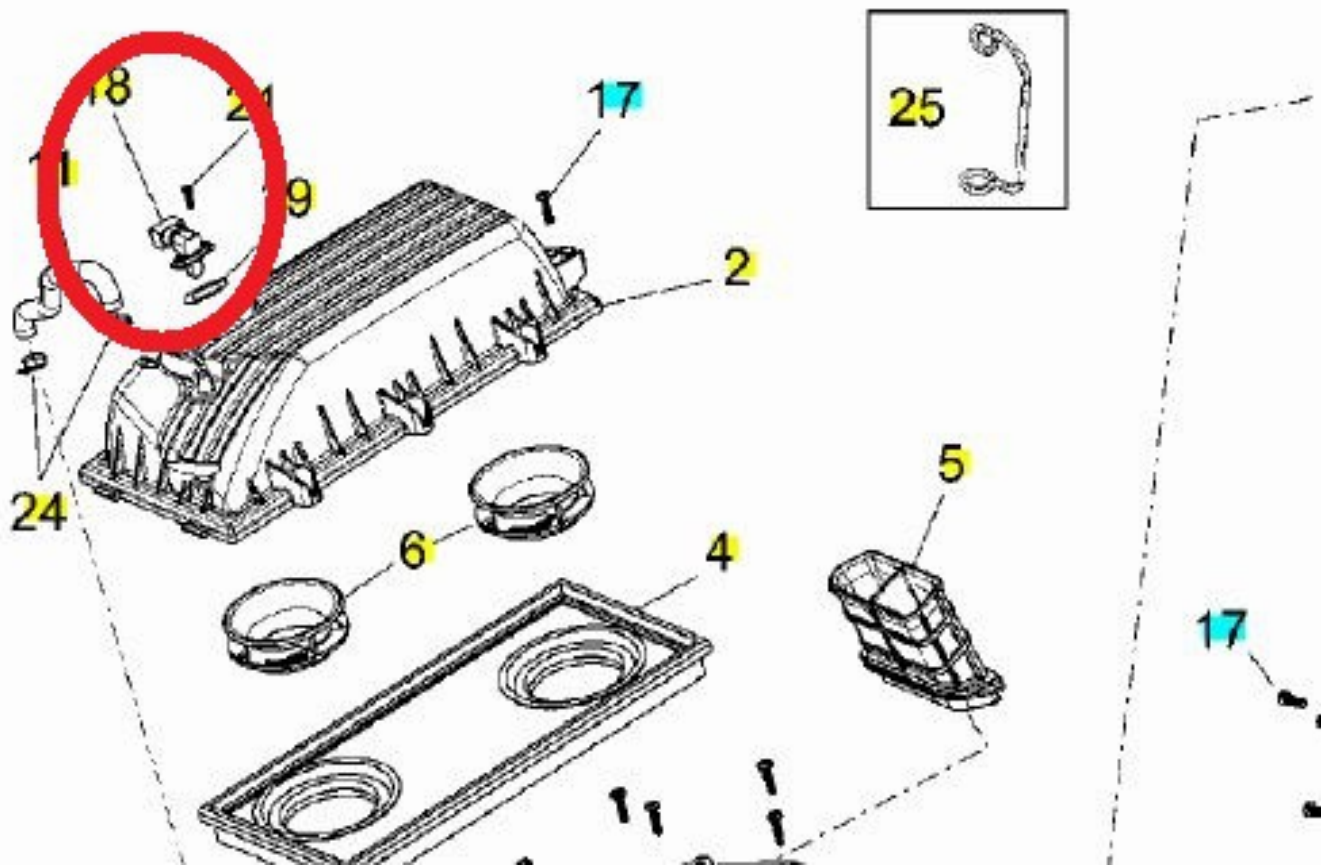

1) REMOVE THE RIDER SADDLE

2) REMOVE THE 2 SIDE PANELS BY UNSCREWING THE SCREWS AND RELEASES

3) REMOVE THE 2 SCREWS OF THE TANK BRACKET

4) RAISE THE TANK MAKING A LOT OF CARE NOT TO FOLD THE PETROL TUBE

5) ON THE SIDE OF THE FILTER CASE FIND THE T. ARIA SENSOR (PHOTO), DISCONNECT IT AND INSTALL THE MEMJET WITH THE RELATIVE THREADS

**1 - The manufacturer, importer or dealer shall not be liable for any incidental damage including personal injury or any other**

**damage caused by improper installation or operation of the JETPRIME product.**

**2 - JETPRIME makes no representation or warranties with regard to damage caused by the improper installation, use and**

**maintenance of his product . The warranty is limited to defects recognized by our technical department and**

**to normal use. The guarantee is void in case of accident,modification, improper or race use.**

**3 - Do not attempt to install the product JETPRIME on a motorcycle for which it was not made or tested by JETPRIME.**

**4 -The technical specifications of JETPRIME products and related products ar subject to change without any notice.**

This product is designed and made in Italy by:



Jetprime S.r.l. società a socio unico

Head Office: Via Eugenio Montale, 1 – 41016 Novi di Modena – Fraz. Rovereto (MO)

Tel: +39 059 672223 – Fax: +39 059 7131226

Email: [info@jetprime.it](mailto:info@jetprime.it) - Web: [www.jetprime.it](http://www.jetprime.it)

All Jetprime S.r.l. products are dedicated exclusively for sports use.